

### PLAN DE SITUATIE

(Intravilan)  
Scara 1:500

Judetul : ARGES  
Unitatea teritoriala adm. : PITESTI  
Cod SIRUTA : 013169  
Adresa corpului de proprietate :  
Mun. Pitesti, str. Aleea Spitalului, nr. 36  
Nr. cadastral al corpului de proprietate:

$S_{total} = 2625,59mp$

$S_1 = 412mp$

$S_2 = 2210,59mp$

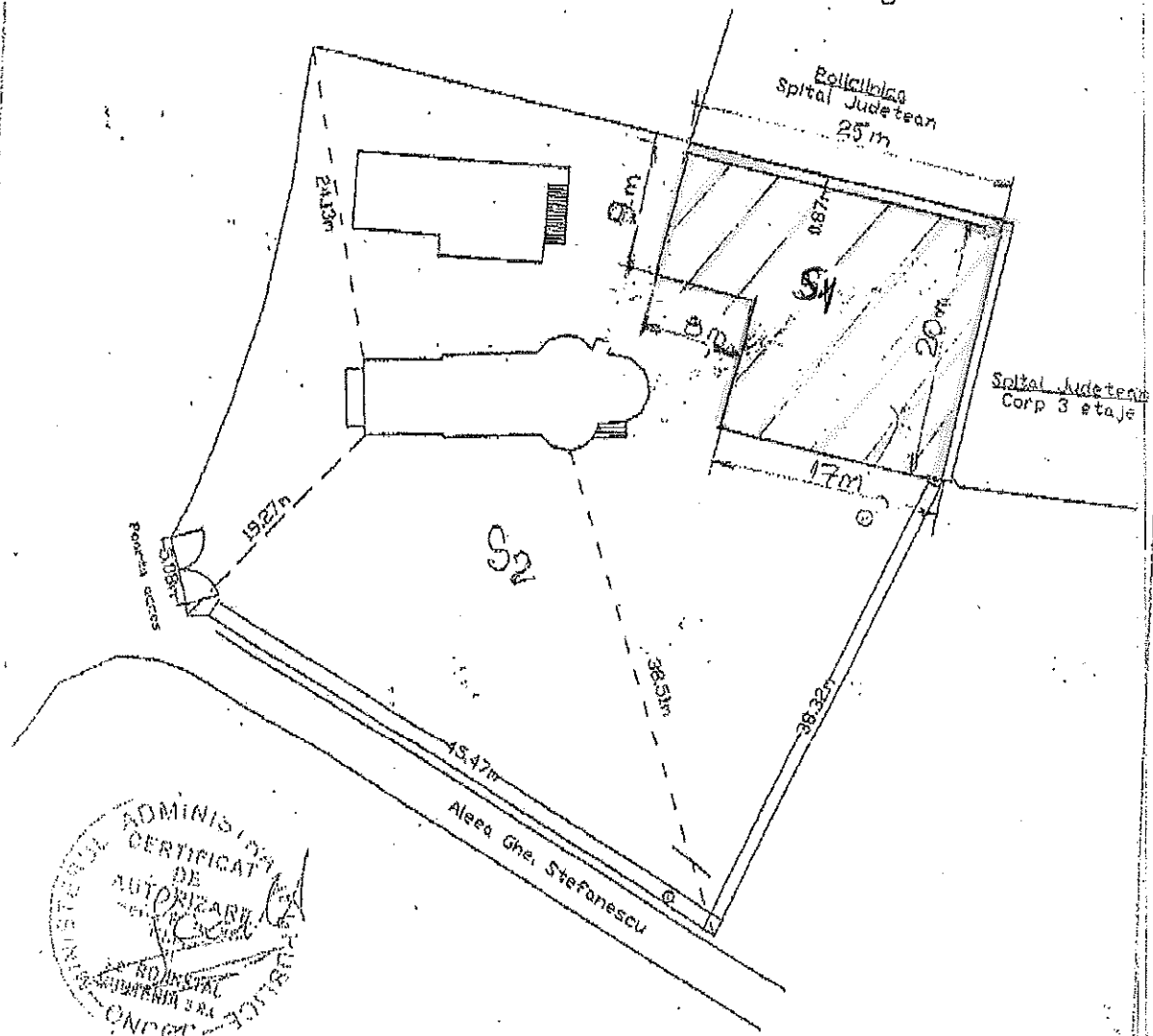
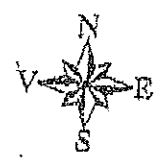

Sistem de proiectie ST 70  
Executant:  
S.C. RO INSTAL MUNTENIA S.R.L.